

HEIGHT GAUGE

Hi_Cal & Hi_Gage ONE

Specially developed and optimized for use in production lines, HI_CAL offers a great efficiency thanks to its large screen which can simultaneously display diameters and centerlines.

Its principal advantages consist in its ease of use, reduced dimensions of its base, its great lightness, the compatibility of the accessories with the instruments of the previous generation and the two travel speeds which offer a great comfort during the measurement of small diameters.

Inductive Sylvac system (patented)

Automatic motorized probe (patented)

Data output RS232 – USB

mm/inch conversion



Height gauge

Hi_Gage ONE

DESCRIPTION

- Intuitive functions
- 400 and 600 mm versions
- Robust mechanics
- PROXIMITY and POWER data outputs

**SWISS
MADE**

D

PROXIMITY

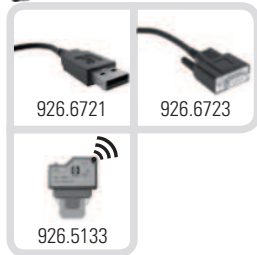

POWER

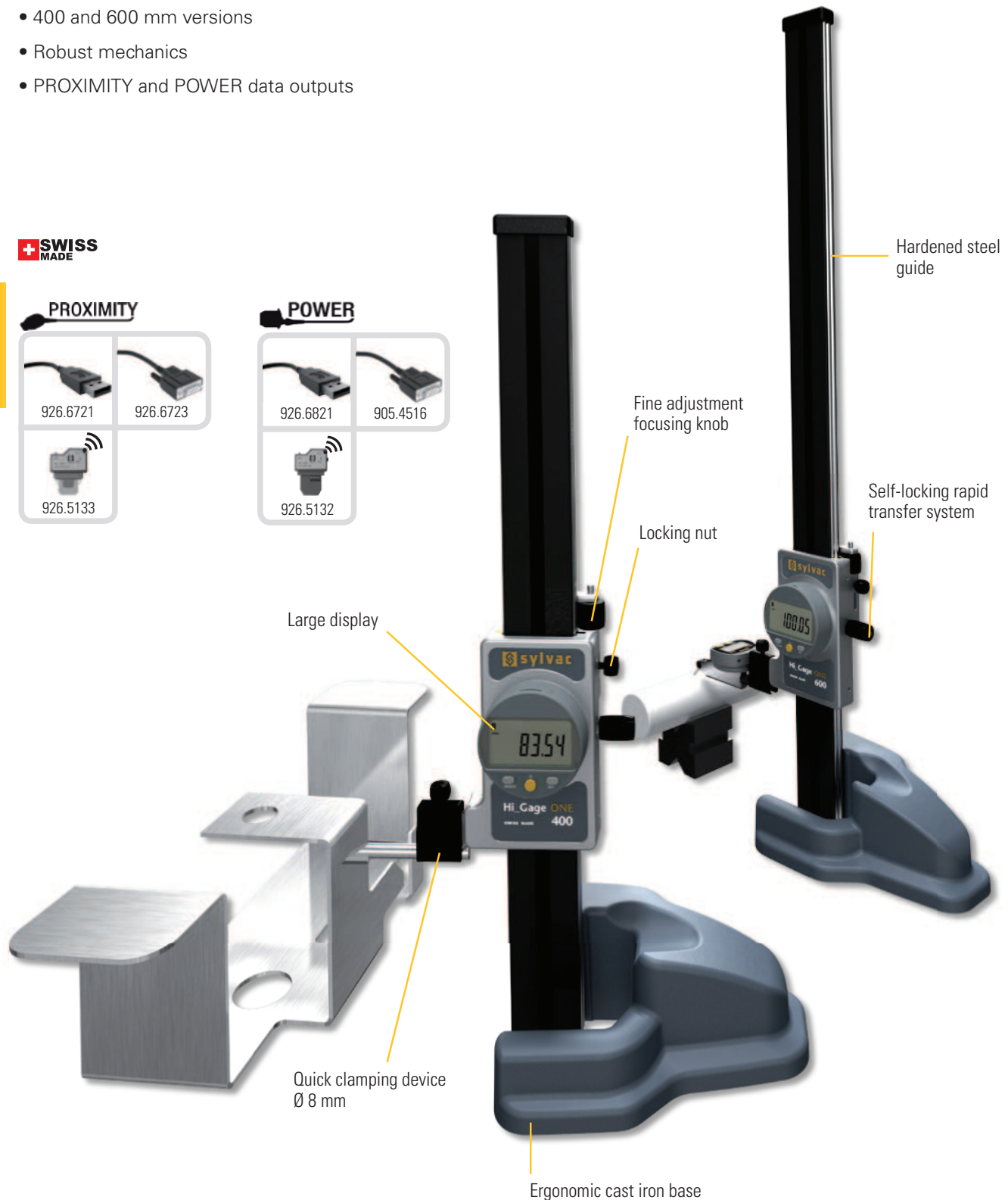
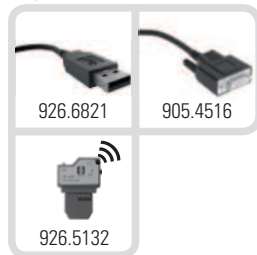

Height gauge

Hi_Gage ONE

DIMENSIONAL DRAWINGS

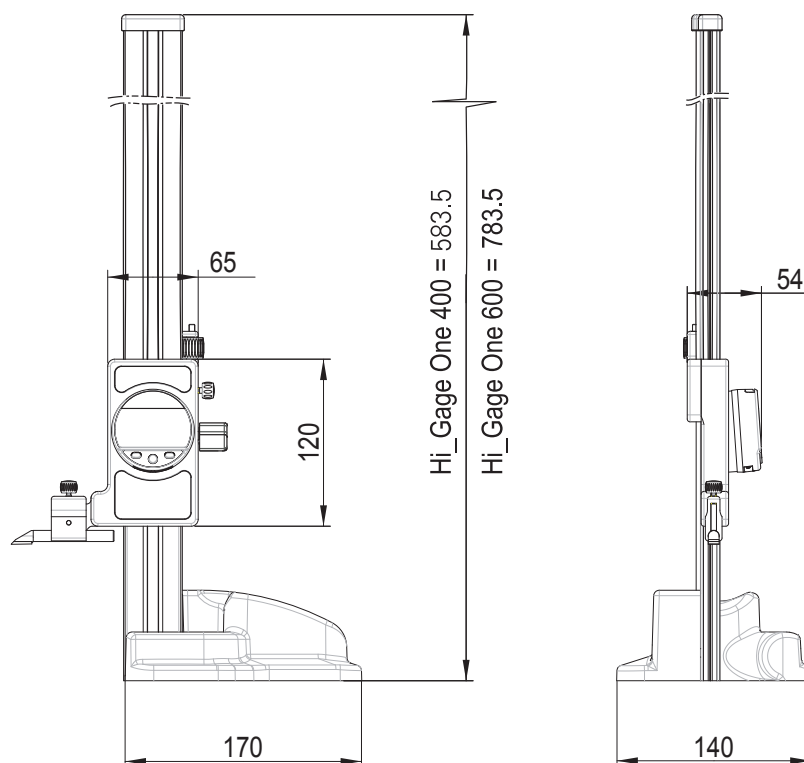

D

TECHNICAL SPECIFICATIONS

	840.0400	840.0600
Measurement range mm	400	600
Resolution mm	0.01	0.01
Max. error μm	40	50
Repeatability μm	10 ¹⁾	10 ¹⁾
2 references	•	•
PRESET	9999.99	
Selection of measuring direction	•	
Smart Inductive Sensor (S.I.S)	•	
S_Connect : Proximity & Power	USB / RS232 / Wireless	

¹⁾ ± 1 digit

ACCESSORIES

	Description
840.9001	Ball probe $\varnothing 8$ mm
840.9002 ¹⁾	Tracing probe
905.2247	Clamping stem

¹⁾ supplied in standard



840.9001



840.9002



905.2247

Height gauge

Hi_Cal

DESCRIPTION

- Intuitive functions
- Great mobility
- Measurement of internal and external diameters, centerlines, heights, thicknesses, depths, surfaces
- 150, 300 and 450 mm range
- Data output USB and RS232
- Extremely low and adjustable measuring force according to the probe
- No influence of the operator on the measurement results
- Battery life: 40 hours
- Probe constant value memorized even when switched off
- **Ergonomic motorized displacement paddle**

D

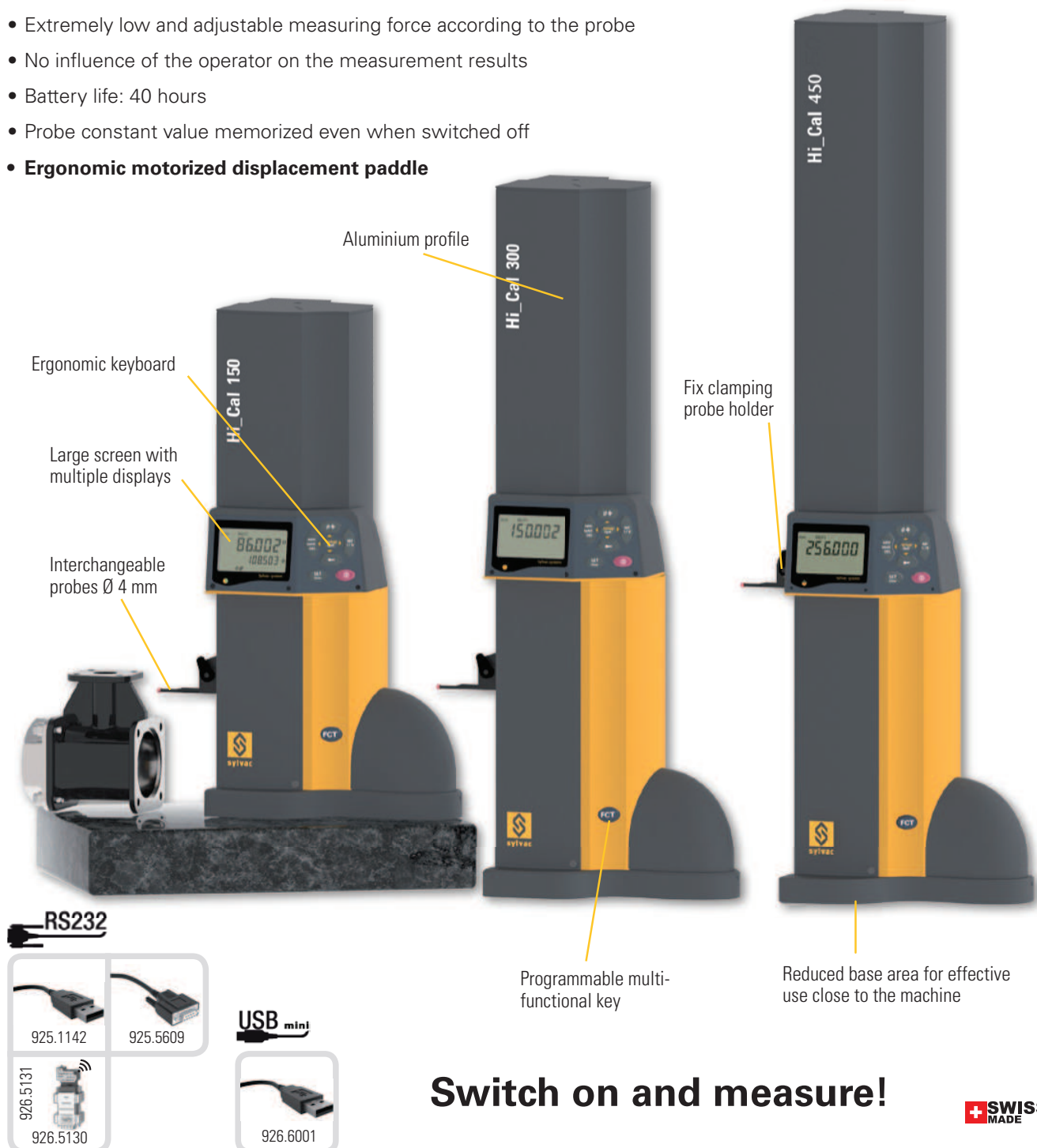

Height gauge

Hi_Cal

DIMENSIONAL DRAWINGS

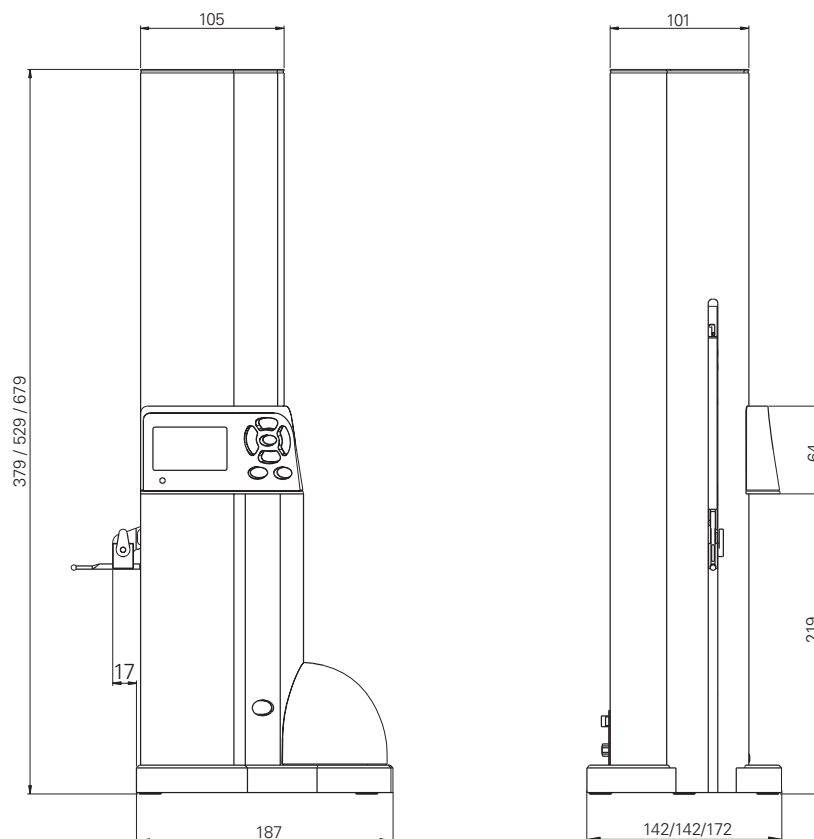

D

DISPLAYS

- ① Measuring unit and active reference
- ② Display of measuring value
- ③ Active measuring mode
- ④ Centerline display
- ⑤ Dynamic measuring mode
- ⑥ Diameter / height measurement
- ⑦ Access to setting menu
- ⑧ Selection of reference Ref I / Ref II
- ⑨ ON / OFF Switch
- ⑩ Ball probe constant
- ⑪ Validation / Initialization of min, max mode
- ⑫ Luminous indication of valid measurement

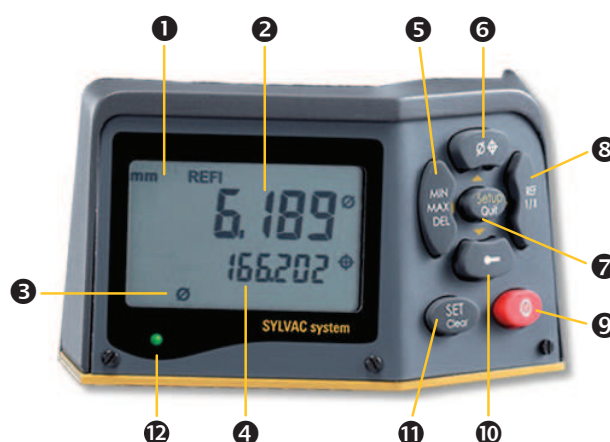

Height gauge

Hi_Cal

TECHNICAL SPECIFICATIONS

		830.0150	830.0300	830.0450
Measuring range	mm	150	300	450
Application range	mm	0 - 155	0 - 320	0 - 470
Max. Error	µm	2.5 + L / 175 ¹⁾		
Repeatability	µm	2		
Resolution	mm	0.01 / 0.001		
Velocity	mm/s	50 / 100		
Measuring force	N	0.2 - 0.3		
Self-contained use	h	>40		
Height	mm	379	529	679
Weight	kg	3.9	4.6	6.8
Weight of the standard probe		7.5g, possibility of using 0-15g or 10-25g ²⁾ probes		
S_Connect		USB / mini USB / RS232 ³⁾		
Programmable by PC		•		
Zero setting		•		
Min / max / delta		•		
PRESET function		•		
2 references		•		
Height measurement, Ø and centerlines		•		
2 types of progressive speed		•		

¹⁾ With standard probe, in laboratory conditions

²⁾ With adjustment of the measuring force

³⁾ See cables chapter

BASIC INSTRUMENT

- Loose cover HI_CAL 150 (930.6001)
- Loose cover HI_CAL 300 (930.6002)
- Loose cover HI_CAL 450 (930.6005)
- Charging set (904.4200¹⁾ / 01/03/04/05)
- Ruby ball probe Ø 3 mm
- Setting gauge
- Calibration certificate
- Instruction manual

¹⁾ according to country

Height gauge

Hi_Cal

APPLICATIONS

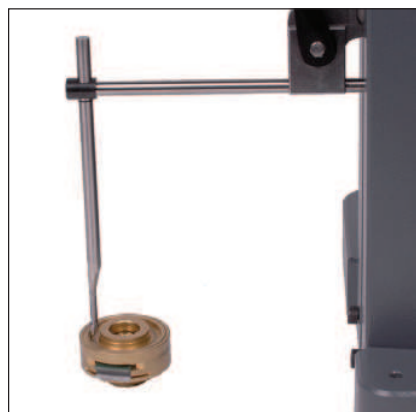

Depth measurement with accessories 930.2108 and 930.2105



Depth measurement with accessories 930.2108 and 905.2204



Internal measurement with ruby ball probe Ø 3 mm, 930.2101 (standard)



Internal groove measurement with accessories 930.2108, 930.2110 and 905.2207



Taking the probe constant value with the setting bloc 930.2002 (standard)

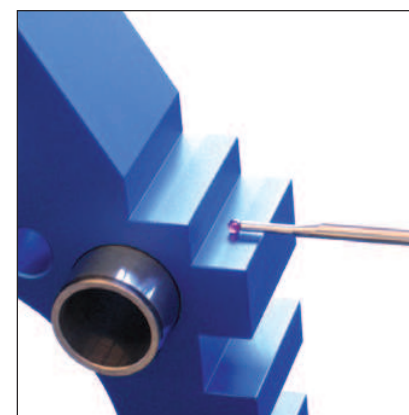

Heights and thicknesses measurements with the standard probe 930.2101

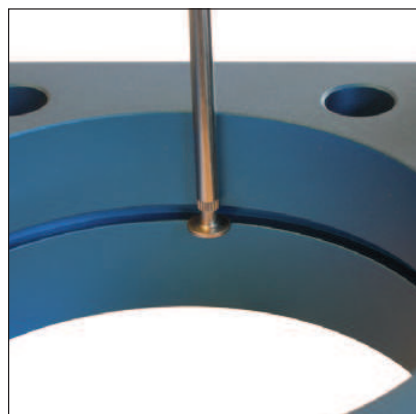

Internal groove measurement with accessories 930.2108, 930.2110 and 905.2205

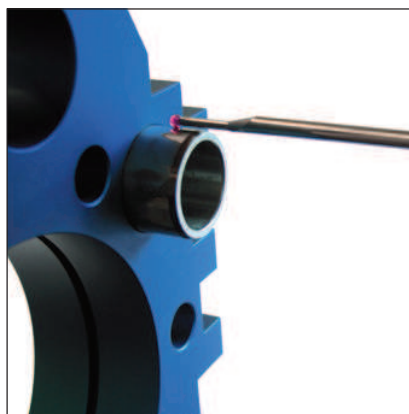

External diameter measurement with the standard probe 930.2101

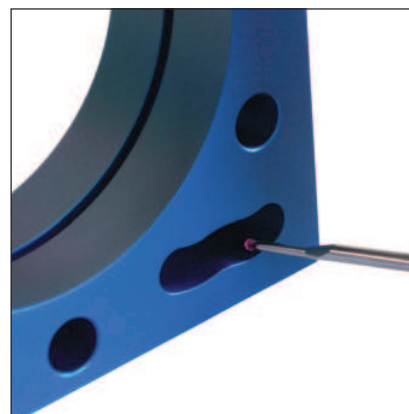

Min/Max/Delta measurements

D

Height gauge

Hi_Cal

ACCESSORIES

D

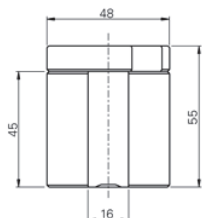
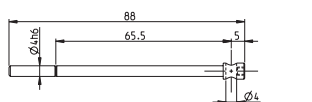
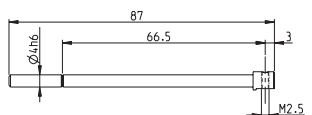
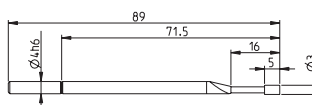
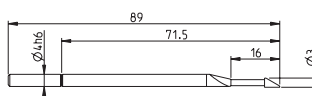
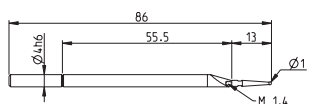
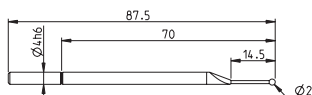
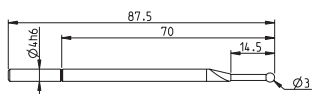

930.2101	Ruby ball probe Ø 3 mm
930.2103	Ruby ball probe Ø 2 mm
930.2104	Tungsten carbide ball probe Ø 1 mm
930.2105	Knife-edged measuring probe TC Ø 3 mm
930.2106	Cylindrical measuring probe TC Ø 3 mm
930.2107	Probe holder 90° M2.5
930.2108	Probe holder 90° Ø 4 mm
930.2002	Setting gauge
904.4200	Charging set 100-240V / 9V
904.4205	EUR cable, included in 904.4000 (CH - 904.4201)
904.4204	UK cable, included in 904.4000
904.4203	USA/JPN cable, included in 904.4000

Height gauge

Hi_Cal

ACCESSORIES

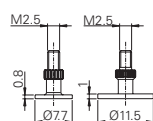
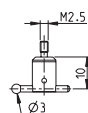
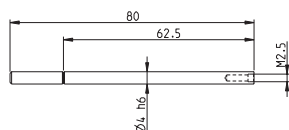
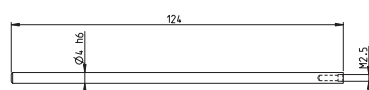
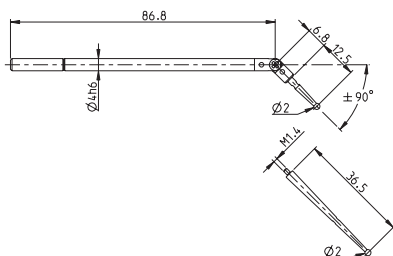

930.2102	Swivelling tungsten carbide ball probe (M1.4)
930.2109	Extension 124 mm M2.5
930.2110	Extension 80 mm M2.5
905.2207	Probe holder and ruby ball probe Ø 3 mm, M2.5
905.2205	Disk shaped anvils Ø 7.7 mm and Ø 11.5 mm, M2.5
930.2150	Full accessory set in wooden box Content : 930.2103, 930.2104, 930.2105, 930.2106, 930.2107, 930.2108, 930.2109, 930.2110, 905.2204, 905.2205, 905.2207
930.2151	Basic accessory set in wooden box Content : 930.2103, 930.2104, 930.2105, 930.2106
904.4101	External contact (foot-pedal)

D

Height gauge

Hi_Cal

ACCESSORIES



930.2111

Carbon probe-holder 200mm, Ø4mm



930.2112

Demonstration piece

D